

Eclipse Flame Safety & Ignition Components

Ignition transformer with 20 mA secondary current. Single phase.

Part No.	Primary Voltage and Frequency	Secondary Voltage
12178	120 VAC / 60 Hz	6000 VAC
15171	240 VAC / 60 Hz	6000 VAC
20683	120 VAC / 50 Hz	6000 VAC
20684	220 VAC / 50 Hz	6000 VAC
20923	110 VAC / 50 Hz	5000 VAC

NOTE: For more ignition transformers see Data 841.

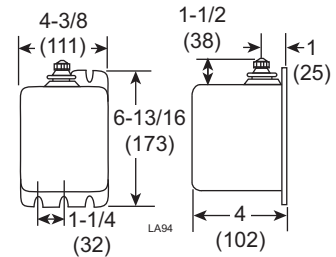

Part number 13551. Honeywell Q-624A-1014 solid state half wave spark generator. Primary: 120 VAC, 66VA secondary; 10,000 VAC.

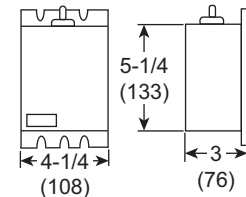

Part number 32756-50FT and 32756-100FT. High temperature ignition wire for maximum of 480°F (250°C).



LA97

Part number 35443-50Ft and 35443-100Ft. GTO-15 ignition cable for maximum ambient temperature of 220°F (105°C).



LA98

Part number 13564-4PC. Rajah 90° fitting with plastic insulator, connects to ignition cable. Snaps onto igniter or flamerod.

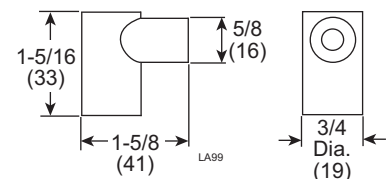

Part number 15996. Terminal, Rajah, straight fitting with half insulation over portion that connects to ignition cable. Snaps onto igniter or flamerod.

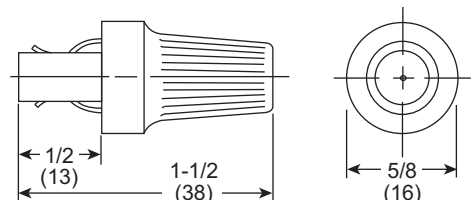

Part number 14202. Terminal, Rajah, straight, maximum 225°F (107°C), use with 14202-1 boot.

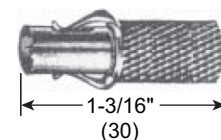

1-3/16" (30)

Part number 14202-1. Terminal Boot, straight, rubber, for use with 14202 terminal.

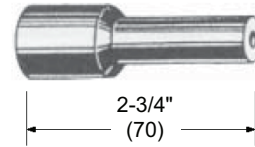

Part number 14204. Terminal, Rajah, right-angle, maximum 225°F (107°C), use with 14204-1 boot.

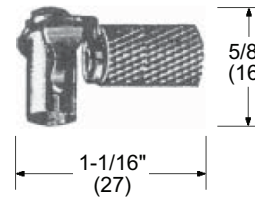

Part number 14204-1. Terminal Boot, right-angle, rubber, used with 14204 terminal.

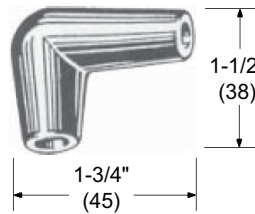

Part number 10008547. Terminal, straight, ceramic, maximum 432°F (220°C).

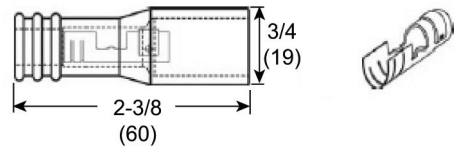

Part number 10008548. Terminal, right-angle, ceramic, maximum 432°F (220°C).

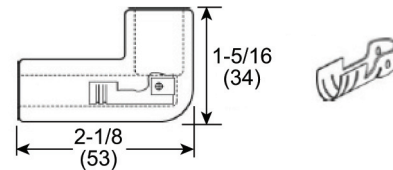

Insulator, ceramic to support electrode rods

Length A		ID		OD		Part No.
Inches	mm	Inches	mm	Inches	mm	
3"	76	0.130"	3.3	9/16"	14	12130
3"	76	0.140"	3.6	7/16"	11	20255

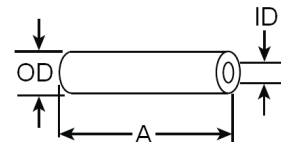

Insulator, ceramic, 1/2" long used to support 1/8" diameter rod inside pipe.

Pipe Size	Part No.
1/2 inch Sch 80	14462-1
3/4 inch Sch 40	14463
3/4 inch Sch 80	14463-1
1 inch Sch 80	14464-1

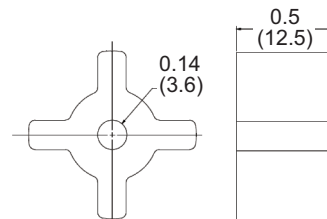

Part number 20403. Insulator, ceramic, used to support 1/8" diameter rod inside pipe diameter minimum of 1.625".

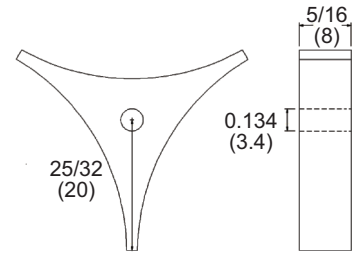

Part number 14320. 3/8" Feed-thru insulator; 4-1/2" lg.

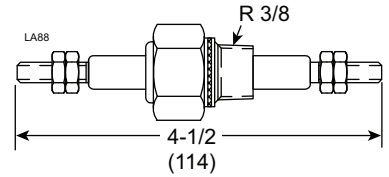

Part number 16219. Flame lead insulator with ignition studs.

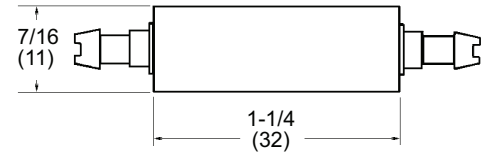

Part number 14319. 1/2" Feed-thru insulator; 4-1/4" lg.

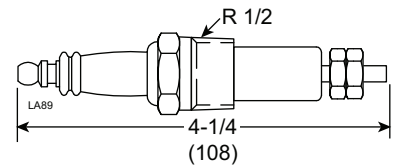

Part number 15908. 1/2" Feed-thru insulator; 9-15/16" lg. for 6-5/8" thick wall insulation.

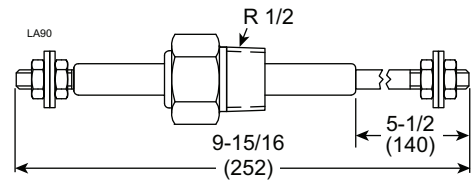

Part number 109031. Flame lead insulator; 1/2" conduit knock-out with ignition stud both ends.

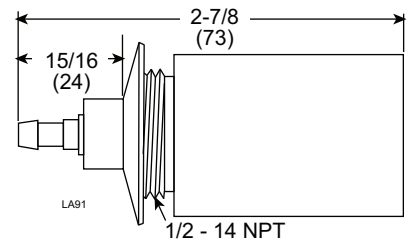

Part number 109345. Feed thru insulator 3/4-14 pipe thds.; 7-3/8" lg. for 5" thick insulation; ignition studs both ends.

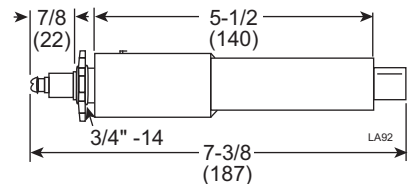

Part number 109344. Feed thru insulator 3/4-14 pipe thds.; 7-3/4" lg. for 5" thick insulation; ignition studs both ends.

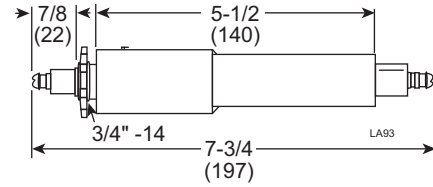

Part number 103401. Swivel adapter to position a flamerod in the flame.

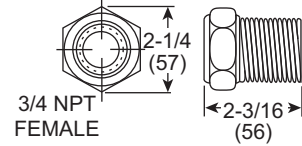

1/4" flamerod

Length A		Part No.
Inches	mm	
1-5/8"	41	13093-5
1-13/16"	46	13093-4
3"	76	13093-3
3-3/4"	95	13093-6
5-3/4"	146	13093
11-3/4"	298	13093-1
17-3/4"	451	13093-2

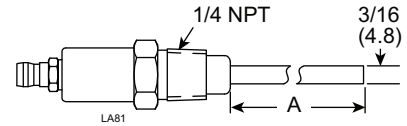

1/4" adjustable flamerod

Length A		Part No.
Inches	mm	
10-1/4"	260	100602-1
16-1/4"	413	100602-2
19-1/4"	489	100602-3
22-1/4"	565	100602-4
25-1/4"	641	100602-5
28-1/4"	717	100602-6
31-1/4"	794	100602-7
34-1/4"	870	100602-8
12.4"	315	100602-9
21-1/4"	540	100602-10
17-1/4"	438	100602-11
29-1/4"	743	100602-12
50-3/4"	1289	100602-13
45.91"	1166	100602-14
59"	1499	100602-15
24"	610	100621
43-1/2"	1105	100629

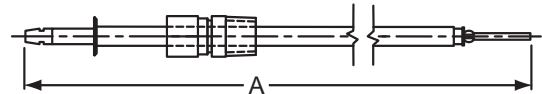

1/4" adjustable self grounding igniters

Length A		Part No.
Inches	mm	
5.9"	152	150000-44
7.0"	178	150000-41
8.8"	226	150000-26
11.1"	282	150000-28
11.8"	302	150000-31
12.9"	328	150000-32
13.8"	353	150000-33
14.8"	378	150000-27
15.9"	404	150000-29
16.8"	429	150000-36
17.9"	455	150000-1
18.8"	480	150000-2
19.8"	505	150000-3
20.9"	531	150000-4
21.8"	556	150000-5
22.9"	582	150000-6
23.1"	588	150000-45
23.8"	607	150000-7
24.8"	632	150000-8
25.9"	658	150000-9
26.8"	683	150000-10
27.9"	709	150000-11
28.8"	734	150000-12
29.8"	759	150000-13
30.9"	785	150000-14
31.8"	810	150000-15
32.9"	836	150000-16
33.8"	861	150000-17
34.8"	886	150000-18
35.9"	912	150000-19
36.8"	937	150000-20
37.9"	963	150000-21
38.8"	988	150000-22
39.8"	1013	150000-23
40.9"	1039	150000-24
41.8"	1064	150000-25
43.8"	1115	150000-38
45.9"	1166	150000-39
47.3"	1203	150000-46
49.8"	1267	150000-37
53.3"	1354	150000-42
54.8"	1394	150000-47
65.9"	1674	150000-40
77.9"	1981	150000-43

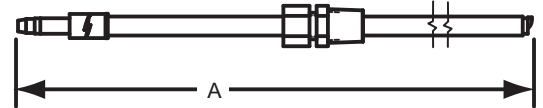

10mm igniter or flamerod.

Length A		Part No.
Inches	mm	
1/2"	12	18461
2-1/2"	63	18460

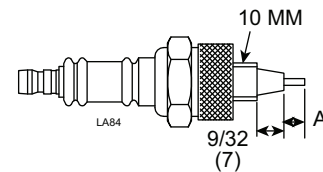

Part number 16160. 10mm self grounding igniter.

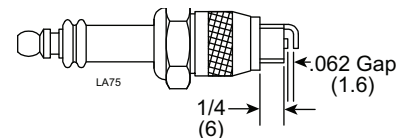

Part number 18458. 10mm self grounding igniter.

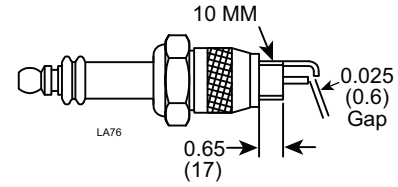

1/2" flamerod

Length A		Part No.
Inches	mm	
1-7/8"	48	13312-3
2-3/8"	60	13312-4
2-1/2"	64	13312-7
3"	76	13312-5
5"	127	13312-8
6"	152	13312
8.82"	224	10002219-3
9-3/4"	248	13312-10
9.98"	253	10002219-1
12"	304	13312-1
12"	305	10002219
24"	610	13312-2

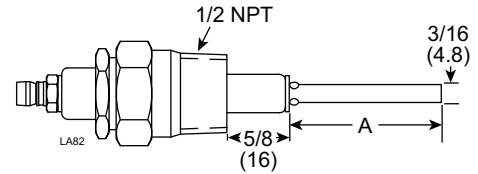

1/2" flamerod

Length A		Part No.
Inches	mm	
18.8"	478	100355-1
22.8"	580	100355-2
26.8"	682	100355-3
30.8"	784	100355-4
34.8"	886	100355-5
38.8"	988	100355-6
42.9"	1090	100355-7
46.9"	1192	100355-8
50.9"	1294	100355-9
54.9"	1396	100355-10

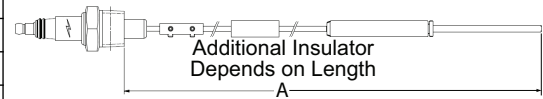

1/2" igniter or flamerod.

Length A		Length B		Part No.
Inches	mm	Inches	mm	
1/2"	12	1/2"	12	16946-6
3/4"	19	1/2"	12	16946-5
1-3/8"	34	1/2"	12	16946-3
1-13/16"	46	1/2"	12	16946-7
2"	50	1/2"	12	16946-9
2-1/2"	63	1/2"	12	16946-4
4-7/16"	112	1/2"	12	16946-2
5"	127	1/2"	12	16946-1
12"	304	1"	25	10002242
24"	609	1"	25	12978
38"	965	1"	25	12978-1

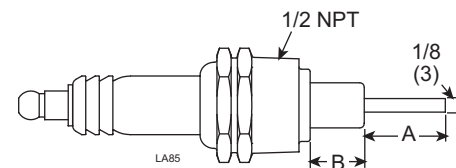

1/2" adjustable igniter or flamerod.

Length A		Length B		Part No.
Inches	mm	Inches	mm	
1"	25	5/8" to 4-1/4"	16 to 108	18193-1
2"	51	3-3/16" to 5-7/16"	81 to 138	20212
3"	76	2-5/8" to 6-1/4"	67 to 159	18193

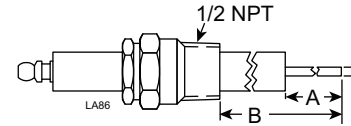

1/2" adjustable igniter or flamerod.

Length A		L1		L2		Part No.
Inches	mm	Inches	mm	Inches	mm	
11.4"	289	9.03"	229	8.06"	204	13837
19.12"	485	16.74"	425	15.79"	401	13581

1/2" igniter or flamerod.

Length A		Length B		Part No.
Inches	mm	Inches	mm	
13-3/4"	349	4-3/4"	120	100050-1
15-7/8"	403	4-3/4"	120	100050-7
16-3/4"	425	4-3/4"	120	100050-2
18-15/16"	481	4-3/4"	120	100050-9
19-3/4"	501	4-3/4"	120	100050-3
21-1/16"	535	4-3/4"	120	100050-5
21-3/4"	552	4-3/4"	120	100050-13
21-15/16"	558	4-3/4"	120	100050-6
22-11/16"	577	4-3/4"	120	100050-11
24-1/16"	611	4-3/4"	120	100050-4
24-1/2"	622	4-3/4"	120	100050-14
24-11/16"	627	1"	25	100670-7
24-15/16"	634	4-3/4"	120	100050-12
25-3/16"	639	1"	25	100670-13
26"	660	4-3/4"	120	100050-10
26-11/16"	678	1"	25	100670-9
26-3/4"	680	4-3/4"	120	100050-8
27-7/16"	697	1"	25	100670-2
27-5/16"	702	4-3/4"	120	100050-15
27-15/16"	710	1"	25	100670-3
30-9/16"	777	1"	25	100670-8
31-3/8"	797	1"	25	100670-12
32-5/8"	828	1"	25	100670-10
32-15/16"	837	1"	25	100670-14
33-3/8"	847	1"	25	100670-1
33-7/8"	860	1"	25	100670-4
38-1/2"	978	1"	25	100670-11
39-1/4"	997	1"	25	100670-5
39-3/4"	1010	1"	25	100670-6

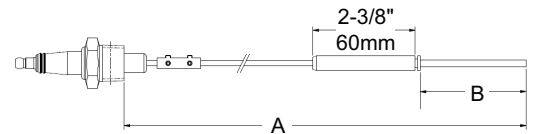

1/2" adjustable flamerod.

Length A		Length B		Part No.
Inches	mm	Inches	mm	
17	432	14	356	10014915-30
18	458	15	382	10014915-31
19	483	16	407	10014915-32
20	509	17	433	10014915-33
21	534	18	458	10014915-34
22	559	19	483	10014915-35
23	585	20	509	10014915-36
24	610	21	534	10014915-1
25	636	22	560	10014915-2
26	661	23	585	10014915-3
27	686	24	610	10014915-4
28	712	25	636	10014915-5
29	737	26	661	10014915-6
30	763	27	686	10014915-7
31	788	28	712	10014915-8
32	813	29	737	10014915-9
33	839	30	763	10014915-10
34	864	31	788	10014915-11
35	890	32	813	10014915-12
36	915	33	839	10014915-13
37	940	34	864	10014915-14
38	966	35	890	10014915-15

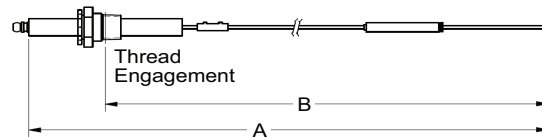

Part number 11941. 1/2" Adjustable igniter or flamerod.

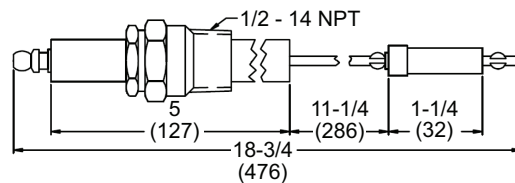

Part number 10034074. 1/2" adjustable igniter.

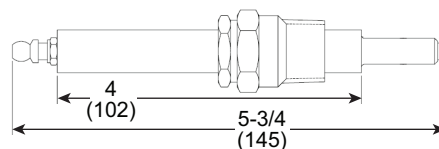

1/2" self grounding igniters.

Length A		Coupling	Insulator	Part No.
Inches	mm			
11-15/16"	287	Yes	No	100173-1*
14-3/16"	361	Yes	No	100205-1
16-5/16"	415	Yes	No	100205-2
17"	432	Yes	No	100205-20
17-1/16"	434	Yes	No	100354-1
18-1/8"	461	No	No	10050564
18-11/16"	474	Yes	No	100205-18
19-5/16"	491	Yes	No	100205-3
19-3/4"	502	Yes	No	100205-21
20-3/4"	527	No	No	10050565
21-1/16"	536	Yes	No	100354-2
22-1/4"	565	Yes	No	100205-12
22-15/16"	582	Yes	No	100205-22
23-15/16"	608	Yes	No	100205-16
25-1/8"	638	Yes	No	100354-3
26-1/8"	664	No	No	10051949
26-3/4"	680	Yes	No	100205-7
27-1/4"	693	Yes	No	100205-8
28-5/16"	720	Yes	No	100205-4
28-15/16"	735	Yes	No	100205-10
29-1/8"	740	Yes	Yes	100354-4
29-13/16"	758	Yes	No	100205-17
30-1/8"	766	Yes	No	100205-19
31-7/8"	809	Yes	No	100205-23
32-1/4"	819	Yes	No	100205-13
32-11/16"	830	Yes	No	100205-6
32-1/8"	842	Yes	Yes	100354-5
33-3/16"	843	Yes	No	100205-9
33-5/16"	847	Yes	No	100205-5
33-15/16"	862	Yes	No	100205-11
37-1/8"	944	Yes	Yes	100354-6
38-9/16"	980	Yes	No	100205-14
39-1/16"	993	Yes	No	100205-15
41-3/16"	1046	Yes	Yes	100354-7
45-3/16"	1148	Yes	Yes	100354-8
49-3/16"	1250	Yes	Yes	100354-9
53-3/16"	1352	Yes	Yes	100354-10

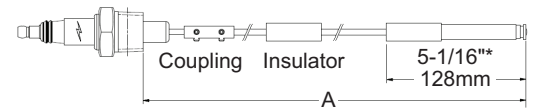

*Except 100173-1, dimension is 2-13/16" (71mm)

1/2" adjustable self grounding igniter.

Length A		Length B		Part No.
Inches	mm	Inches	mm	
19-1/2"	495	14"	356	100640-1
20-1/2"	521	15"	381	100640-2
21-1/2"	546	16"	406	100640-3
22-1/2"	572	17"	432	100640-4
23-1/2"	597	18"	457	100640-5
24-1/2"	622	19"	483	100640-6
25-1/2"	648	20"	508	100640-7
26-1/2"	673	21"	533	100640-8
27-1/2"	699	22"	559	100640-9
28-1/2"	724	23"	584	100640-10
29-1/2"	749	24"	610	100640-11
30-1/2"	775	25"	635	100640-12
31-1/2"	800	26"	660	100640-13
32-1/2"	826	27"	686	100640-14
33-1/2"	851	28"	711	100640-15
9-3/4"	248	4-1/4"	108	100640-16
38-1/2"	978	33"	838	100640-17
35-1/2"	902	30"	762	100640-18
12-1/2"	318	7"	178	100640-30
13-1/2"	343	8"	203	100640-31
14-1/2"	368	9"	229	100640-32
15-1/2"	394	10"	254	100640-33
16-1/2"	419	11"	279	100640-34
17-1/2"	445	12"	305	100640-35
18-1/2"	470	13"	330	100640-36

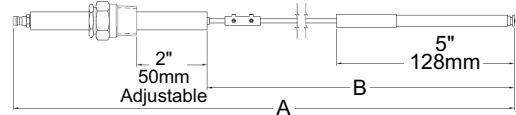

1/2" self grounding igniters.

Length A		Gap	Part No.
Inches	mm		
1.72	43	0.090	10089
2.21	56	0.125	11576
4-1/8"	104	0.125	12568
4.550"	115	0.125	17396
5-1/8"	130	0.063	17652

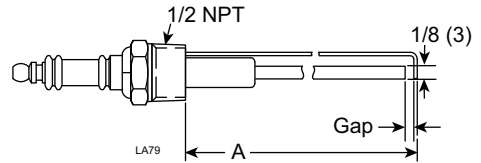

14mm self grounding igniters.

Length A		Gap		Part No.
Inches	mm	Inches	mm	
1"	25	.07"	1.7	17071
1-1/2"	38	.10"	2.5	16927
1-3/4"	45	.10"	2.5	10002322

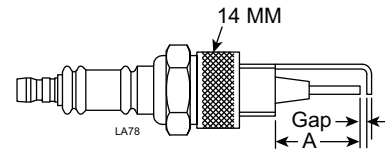

14mm self grounding igniter.

Length A		Gap		Part No.
Inches	mm	Inches	mm	
1-5/16"	29.5	0.06"	1.5	13047
1-5/16"	29.5	0.06"	1.5	13047-2*
1-5/8"	41.5	0.06"	1.5	13047-1
2-3/4"	70	0.06"	1.5	10019728
4"	101	0.06"	1.5	23045
4.33"	110	0.06"	1.5	10014597

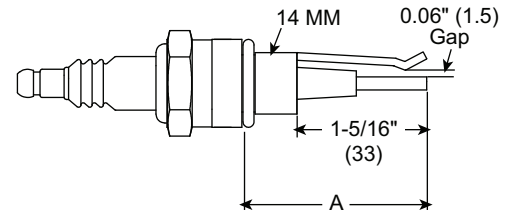

* Terminal is not removable

3/4" flamerod.

Length A		Part No.
Inches	mm	
6"	152	14265-1
12"	304	14265-2
18"	457	14265-3

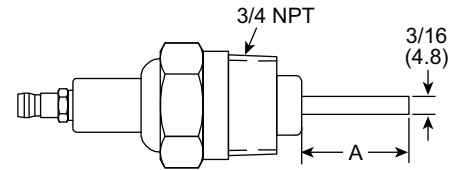

3/4" igniter or flamerod.

Length A		Part No.
Inches	mm	
2-3/8"	60	12392-4
6"	152	12392
12"	304	12392-3
26"	660	12392-1
54"	1371	12392-2

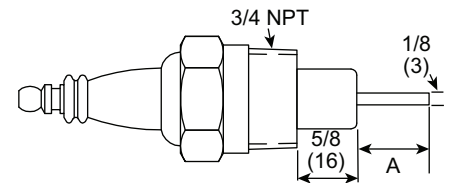

3/4" Igniter.

Length A		Part No.
Inches	mm	
24.33"	618	100216-1
28-1/8"	714	100224-1

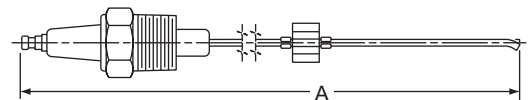

3/4" self grounding igniters with stainless steel sleeve.

Length A		Part No.
Inches	mm	
4-1/4"	107	13499
6"	152	13499-1
9"	228	13499-2

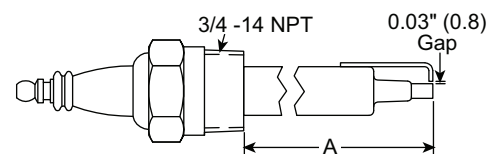

3/4" Igniter.

Length A		Part No.
Inches	mm	
12-1/2"	318	103162-1
18-1/2"	470	103162-2
24.48"	622	103162-3

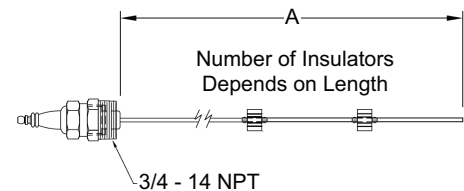

1" Igniter.

Length A		Part No.
Inches	mm	
13.3"	340	103162-4
19.3"	492	103162-5
25.4"	645	103162-6
37.4"	950	103162-7
15.9"	406	103162-8
41.4"	1054	103162-9
49.4"	1257	103162-10
61.4"	1562	103162-11

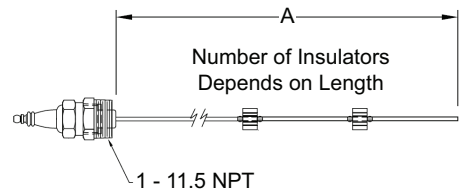

1-1/4" Igniter.

Length A		Length B		Part No.
Inches	mm	Inches	mm	
40-15/16"	1040	5-1/8"	130	900287
42-11/16"	1085	5-7/8"	150	900288
47-13/16"	1215	5-7/8"	150	900289

